

GEARex® FR and DR

All-steel gear couplings

Morskate®

Single-cardanic, high power density

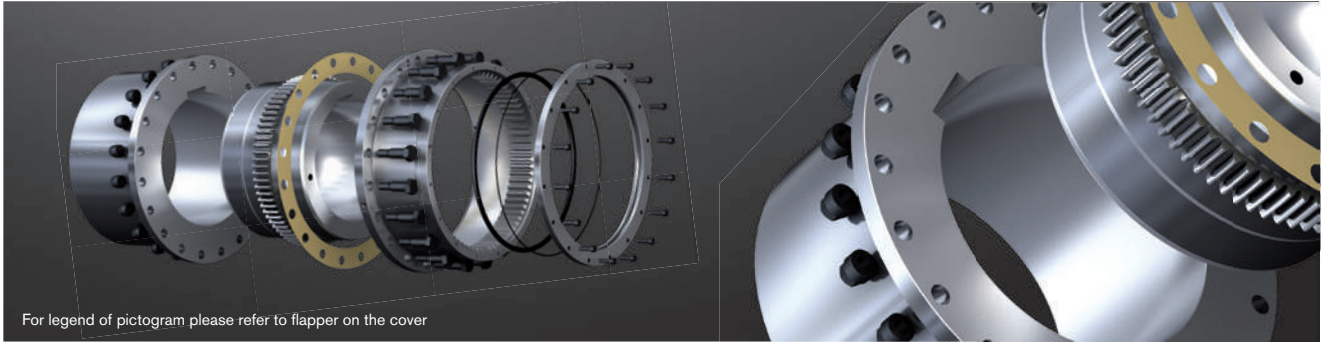

For legend of pictogram please refer to flapper on the cover

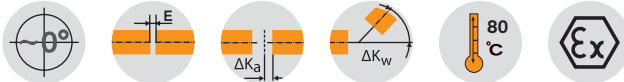

| Dimensions | | | | | | | | | | | | | | | | | |
|------------------|-----------------|---------------------------|------------------|----------------|---------------------------------|---|-----|-------------------|-------------------|-------|------|-----------------|------------------------------|--------------------|-----|------------------------------------|---------------------|
| Size | Torque [Nm] | | Max. finish bore | | Dimensions [mm] | | | | | | | | | Dowel screw (10.9) | | Grease capacity [dm ³] | |
| | T _{KN} | T _{KN} (42CrMo4) | d ₁ | d ₄ | l ₁ , l ₂ | Hub lengthened max. l ₁ , l ₂ | D | DA1 ²⁾ | DA2 ²⁾ | DF | LR | F ¹⁾ | d ₃ ¹⁾ | z | M | | T _A [Nm] |
| 10 ³⁾ | 930 | 1580 | 50 | 60 | 43 | 105 | 67 | 111 | 84 | 84 | 88 | 74 | 52 | 6 | M6 | 15 | 0.02 |
| 15 ³⁾ | 2000 | 3300 | 64 | 78 | 50 | 115 | 87 | 152 | 107 | 107 | 103 | 84 | 68 | 8 | M8 | 36 | 0.04 |
| 20 | 3500 | 6300 | 80 | 95 | 62 | 130 | 108 | 178 | 130 | 130 | 127 | 104 | 85 | 6 | M10 | 72 | 0.08 |
| 25 | 6500 | 11000 | 98 | 115 | 76 | 150 | 130 | 213 | 158 | 158 | 157 | 123 | 110 | 6 | M12 | 125 | 0.12 |
| 30 | 10000 | 17400 | 112 | 135 | 90 | 170 | 153 | 240 | 182 | 182 | 185 | 148 | 130 | 8 | M12 | 125 | 0.18 |
| 35 | 17000 | 28800 | 133 | 155 | 105 | 185 | 180 | 280 | 214 | 214 | 216 | 172 | 150 | 8 | M14 | 200 | 0.22 |
| 40 | 28500 | 48500 | 158 | 185 | 120 | 215 | 214 | 318 | 250 | 250 | 244 | 192 | 175 | 8 | M14 | 200 | 0.35 |
| 45 | 37000 | 62000 | 172 | 200 | 135 | 245 | 233 | 347 | 274 | 274 | 276 | 216 | 190 | 10 | M14 | 200 | 0.45 |
| 50 | 51000 | 86000 | 192 | 225 | 150 | 295 | 260 | 390 | 309 | 309 | 305 | 241 | 220 | 8 | M18 | 430 | 0.70 |
| 55 | 65000 | 110000 | 210 | 245 | 175 | 300 | 283 | 425.5 | 334 | 334 | 356 | 275 | 250 | 14 | M18 | 430 | 0.90 |
| 60 | 85000 | 145000 | 232 | 265 | 190 | 305 | 312 | 457 | 365.5 | 365.5 | 386 | 316 | 265 | 14 | M18 | 430 | 1.15 |
| 70 | 135000 | 240000 | 276 | 310 | 220 | 310 | 371 | 527 | 425 | 425 | 450 | 360 | 300 | 16 | M20 | 610 | 1.50 |
| 80 | 175000 | 300000 | 300 | 340 | 280 | - | 394 | 545 | 475 | 462 | 570 | 340 | 310 | 18 | M20 | 610 | 2.50 |
| 85 | 225000 | 380000 | 325 | 370 | 292 | - | 430 | 585 | 515 | 500 | 597 | 352 | 330 | 20 | M20 | 610 | 3.00 |
| 90 | 290000 | 500000 | 350 | 400 | 305 | - | 464 | 640 | 560 | 546 | 623 | 365 | 360 | 20 | M24 | 1000 | 4.00 |
| 100 | 380000 | 650000 | 390 | 440 | 330 | - | 512 | 690 | 612 | 594 | 673 | 390 | 400 | 24 | M24 | 1000 | 5.00 |
| 110 | 480000 | 820000 | 420 | 480 | 350 | - | 560 | 765 | 665 | 647 | 710 | 410 | 420 | 20 | M30 | 1700 | 6.00 |
| 120 | 620000 | 1050000 | 450 | 520 | 420 | - | 608 | 825 | 720 | 700 | 852 | 480 | 470 | 24 | M30 | 1700 | 7.50 |
| 130 | - | 1450000 | 500 | 560 | 440 | - | 684 | 950 | 805 | 760 | 890 | 520 | 520 | 20 | M36 | 2800 | 9.00 |
| 140 | - | 1950000 | 550 | 610 | 460 | - | 750 | 1020 | 875 | 835 | 930 | 570 | 590 | 24 | M36 | 2800 | 12.00 |
| 150 | - | 2750000 | 630 | 690 | 520 | - | 850 | 1140 | 975 | 935 | 1055 | 630 | 670 | 30 | M36 | 2800 | 15.00 |

■ = Standard

¹⁾ Space required to align the coupling and replace the gasket

²⁾ For dimension type F see page 108. For type D see page 110.

³⁾ Only available as type F

| | | | |
|-------------------|---------------------------|---|---|
| Ordering example: | GEARex® FR 10 | d ₁ Ø50 | d ₄ Ø60 |
| | Type and size of coupling | Finish bore with keyway to DIN 6885 sheet 1 | Finish bore with keyway to DIN 6885 sheet 1 |

Any questions? Please contact us.

Morskate Aandrijvingen BV

Oosterveldsingel 47A
7558 PJ Hengelo (Ov)
The Netherlands

NL

T +31 (0)74 - 760 11 11
info@morskateaandrijvingen.nl
www.morskateaandrijvingen.nl

DE

T +49 692 - 222 34 95
info@morskateantriebstechnik.de
www.morskateantriebstechnik.de

EN

T +31 (0)74 - 760 11 11
info@morskatedrivetechnology.com
www.morskatedrivetechnology.com

Components

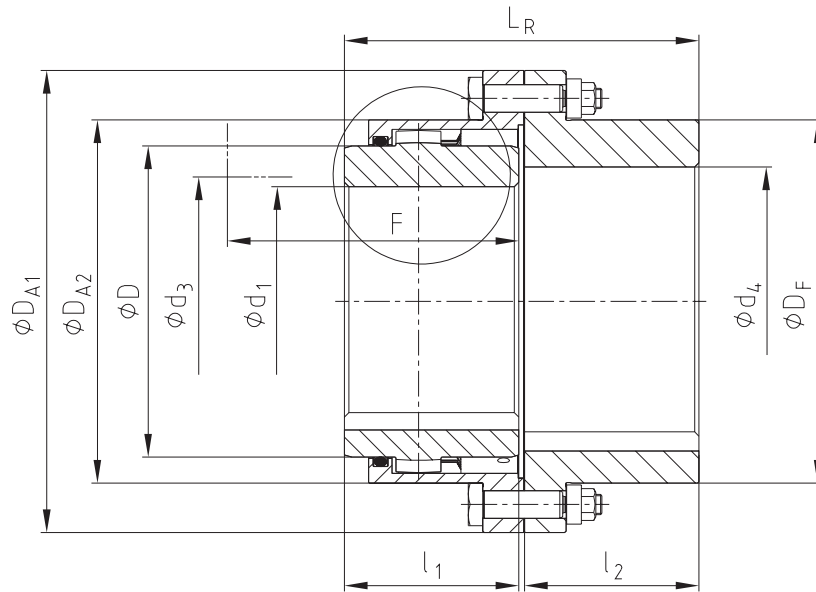

BoWex®

Types

Type FR

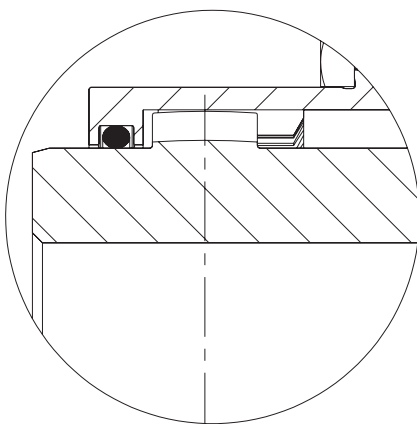

Type DR

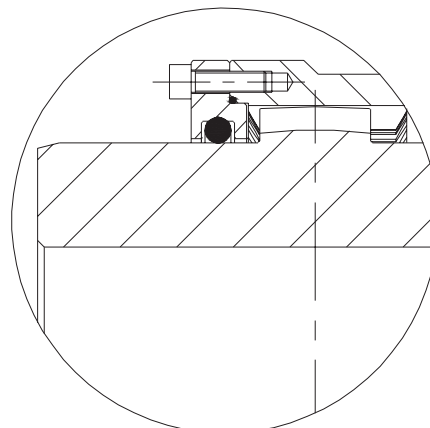

GEARex®

Any questions? Please contact us.

Morskate Aandrijvingen BV

Oosterveldsingel 47A
7558 PJ Hengelo (Ov)
The Netherlands

NL

T +31 (0)74 - 760 11 11
info@morskateaandrijvingen.nl
www.morskateaandrijvingen.nl

DE

T +49 692 - 222 34 95
info@morskateantriebstechnik.de
www.morskateantriebstechnik.de

EN

T +31 (0)74 - 760 11 11
info@morskatedrivetechnology.com
www.morskatedrivetechnology.com

Displacements

Axial displacement

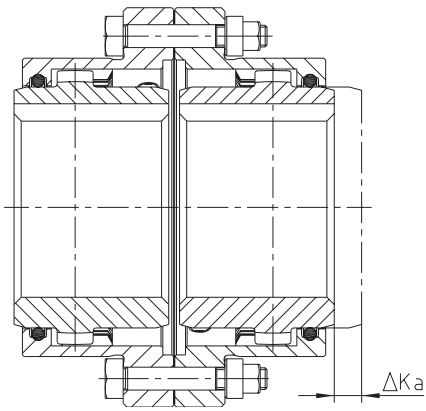

Radial displacement

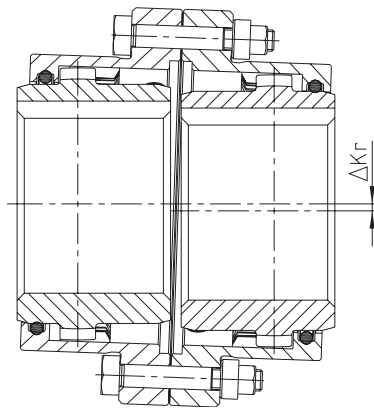

Angular displacement

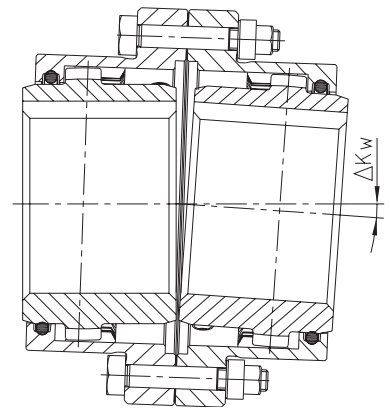

| Displacements | | | |
|---------------|----------------------------------|--|---------------|
| Size | Max. axial displacement ΔKa [mm] | Max. permissible displacements ¹⁾ | |
| | | ΔKr [mm] | ΔKw [°] |
| 10 | | ± 0.4 | |
| 15 | | ± 0.5 | |
| 20 | | ± 0.6 | |
| 25 | ± 1.0 | ± 0.8 | |
| 30 | | ± 1.0 | |
| 35 | | ± 1.0 | |
| 40 | | ± 1.2 | |
| 45 | | ± 1.4 | |
| 50 | | ± 1.6 | |
| 55 | ± 1.5 | ± 1.8 | |
| 60 | | ± 2.0 | 0.5° each hub |
| 70 | | ± 2.2 | |
| 80 | | ± 2.5 | |
| 85 | | ± 2.8 | |
| 90 | ± 2.0 | ± 3.0 | |
| 100 | | ± 3.2 | |
| 110 | | ± 4.4 | |
| 120 | | ± 5.5 | |
| 130 | | ± 5.7 | |
| 140 | ± 2.5 | ± 6.0 | |
| 150 | | ± 6.6 | |

¹⁾ The displacement figures are maximum figures which must not arise in parallel. If radial and angular displacements arise in parallel, the figures need to be reduced (see examples of calculation and diagramme).

Example 1:
ΔKr = 30%
ΔKw = 70%

Example 2:
ΔKr = 60%
ΔKw = 40%

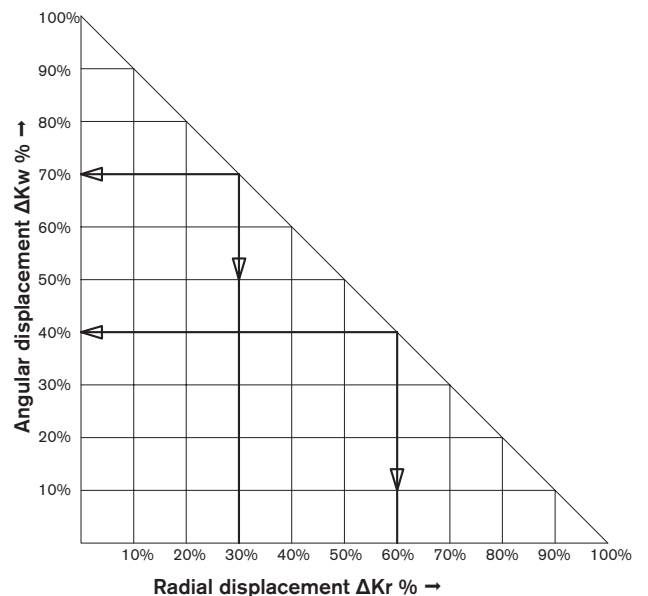

Flange dimensions in accordance with AGMA 9008-B00

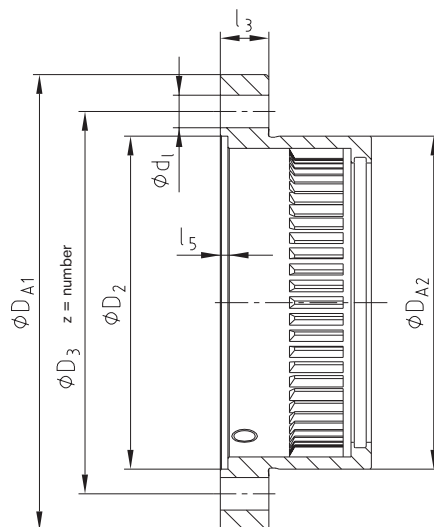

BoWex[®]

Gear couplings

| Flange dimensions | | | | | | | | |
|-------------------|-----------------|----------|-------|--------|-------|---------------------|-------|-------|
| Size | Dimensions [mm] | | | | | | | |
| | D_{A1} | D_{A2} | D_2 | D_3 | d_1 | $z = \text{number}$ | l_3 | l_5 |
| 10 | 111 | 84 | 82 | 95.25 | 6.35 | 6 | 14 | 3 |
| 15 | 152 | 107 | 105 | 122.24 | 9.52 | 8 | 19 | 3 |
| 20 | 178 | 130 | 130 | 149.23 | 12.70 | 6 | 19 | 3 |
| 25 | 213 | 158 | 153 | 180.97 | 15.87 | 6 | 22 | 4 |
| 30 | 240 | 182 | 178 | 206.38 | 15.87 | 8 | 22 | 4 |
| 35 | 280 | 214 | 205 | 241.30 | 19.05 | 8 | 28.5 | 5 |
| 40 | 318 | 250 | 243 | 279.40 | 19.05 | 8 | 28.5 | 4 |
| 45 | 347 | 274 | 265 | 304.80 | 19.05 | 10 | 28.5 | 5.5 |
| 50 | 390 | 309 | 302 | 342.90 | 22.22 | 8 | 38 | 6 |
| 55 | 425.5 | 334 | 320 | 368.30 | 22.22 | 14 | 38 | 6 |
| 60 | 457 | 365.5 | 353 | 400.05 | 22.22 | 14 | 26 | 6 |
| 70 | 527 | 425 | 412 | 463.55 | 25.40 | 16 | 28.5 | 8 |

Other types

Type SD

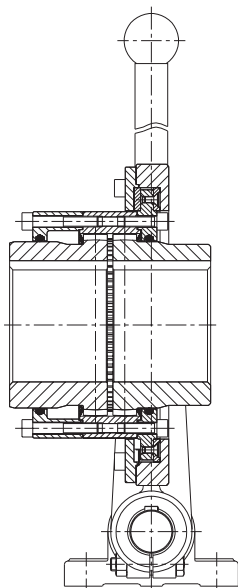

Type with brake disk

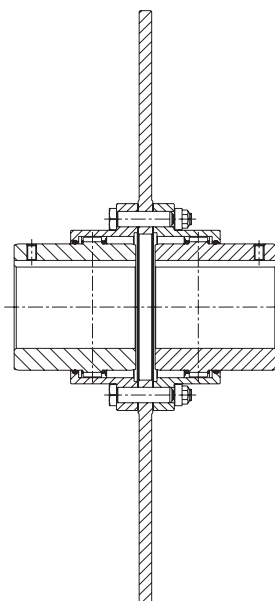

Type VD (vertical assembly)

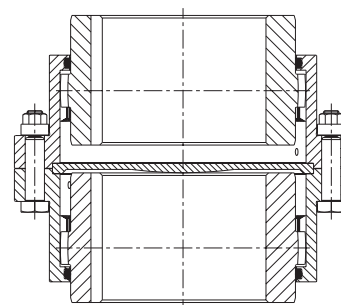

GEARex[®]

Morskate®



Any questions? Please contact us.

Morskate Aandrijvingen BV

Oosterveldsingel 47A
7558 PJ Hengelo (Ov)
The Netherlands

NL

T +31 (0)74 - 760 11 11
info@morskateaandrijvingen.nl
www.morskateaandrijvingen.nl

DE

T +49 692 - 222 34 95
info@morskateantriebstechnik.de
www.morskateantriebstechnik.de

EN

T +31 (0)74 - 760 11 11
info@morskatedrivetechnology.com
www.morskatedrivetechnology.com