

BoWex-ELASTIC® HEW Compact Curved-tooth gear coupling®

Compensating for large displacements, very compact design

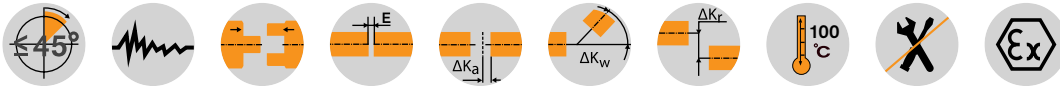

For legend of pictogram refer to flapper on the cover



BoWex-ELASTIC® type HEW Compact																							
Size	Dimensions [mm]																			Weight with pilot bored coupling [kg]	Mass moment of inertia with pilot bored coupling [kgm²]		
	Max. finish bore		L		L1		L2	E		DA	DN	DN1	D4	D7	B1	NH	Z	M	JA		JL1	JL2	
	D	D1	HEW1	HEW2	HEW1	HEW2		HEW1	HEW2														
42-130	42	42	118	98	42	42	42	34	14	131	65	65	78	90	45	37	6	M6	3.4	0.003	0.001	0.001	
60-180	65	60	145	122	55	55	60	30	7	180	98	85	110	130	44	47	8	M10	9.0	0.014	0.006	0.006	
80-225	90	75	210	158	90	70	70	50	18	225	124	100	120	145	77	51	10	M12	18.9	0.035	0.029	0.021	
100-305	100	100	258	187	110	70	90	58	17	305	152	170	175	200	90	73	16	M12	40.2	0.152	0.087	0.068	
125-365	125	125	328	240	140	100	120	68	20	365	192	170	205	230	105	90	12	M16	75.0	0.360	0.260	0.192	

Technical data															
Coupling size	Elastomer hardness [Shore A]	Torque [Nm]			Perm. speed n _{max} [rpm]	Perm. damping power			Dynamic torsion spring stiffness C _{dyn} [Nm/rad]	Relative damping ψ	Resonance factor V _R =2·Π/ψ	Radial spring stiffness C _r [N/mm]			
		T _K	T _K max.	with 10 Hz T _{KW}		P _{KW}									
						60 °C	80 °C	90 °C							
42 HEW Compact	T50	200	400	50	7300	30	18	12	780	0.8	7.9	178			
	T65	270	540	68					2400				1.2	5.2	600
	T70	320	640	80					2900						
65 HEW Compact	T50	550	1100	138	5500	55	33	22	2850	0.8	7.9	379			
	T65	740	1500	185					7800				1.2	5.2	955
	T70	860	1700	215					9500						
80 HEW Compact	T50	1250	2500	313	4400	90	54	36	5000	0.8	7.9	420			
	T65	1600	3200	400					13000				1.2	5.2	1090
	T70	1900	3800	475					16500						
100 HEW Compact	T50	2750	5500	688	3200	150	90	60	17000	0.8	7.9	760			
	T65	3900	7800	975					44000				1.2	5.2	1850
	T70	4500	9000	1125					50000						
125 HEW Compact	T50	5500	11000	1375	2900	220	132	88	25000	0.8	7.9	750			
	T65	7500	15000	1875					62000				1.2	5.2	1930
	T70	8400	16800	2100					70000						

Ordering example:	BoWex® 65 HEW Compact	T50	d ₁ Ø40	d ₂ Ø65
	Size and type of coupling	Elastomer hardness	Finish bore H7 keyway to DIN 6885 sheet 1 (JS9)	Finish bore H7 keyway to DIN 6885 sheet 1 (JS9)

BoWex-ELASTIC® HEW1 Compact

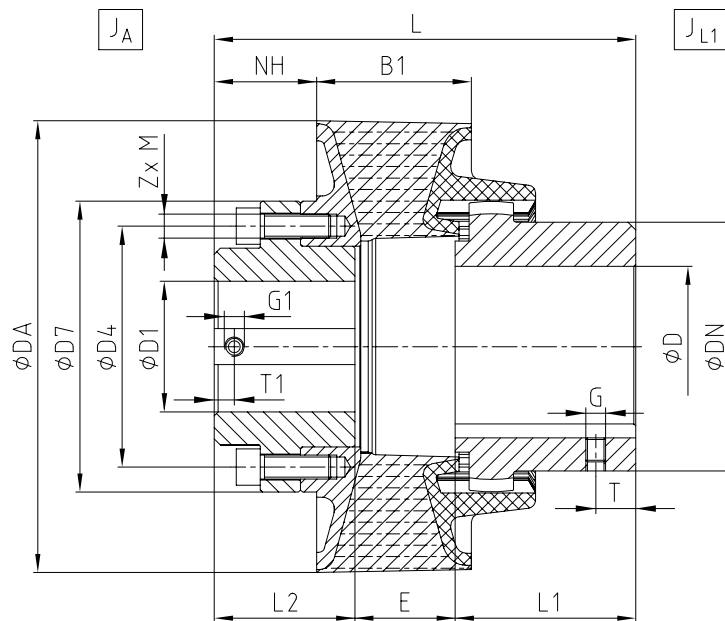

BoWex-ELASTIC® HEW2 Compact (with reduced hub)

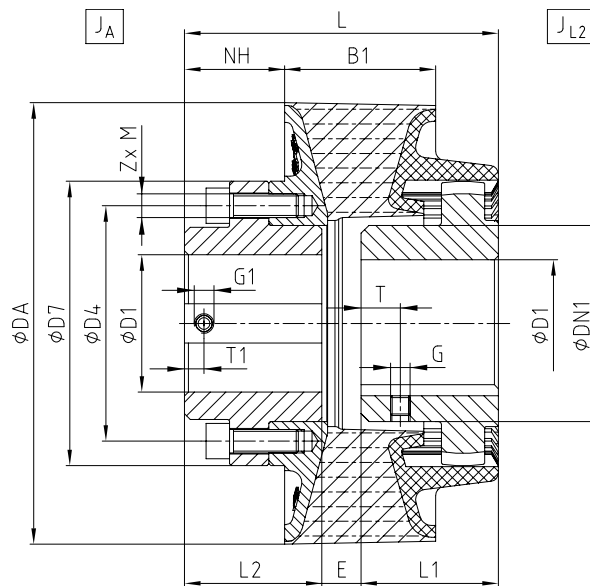

Displacements – type HEW Compact															
BoWex-ELASTIC® size	42-130			65-180			80-225			100-305			125-365		
Elastomer hardness [Shore A]	T50	T65	T70	T50	T65	T70	T50	T65	T70	T50	T65	T70	T50	T65	T70
Max. axial displacement ΔK_a [mm]	± 2			± 2			± 2			± 2			± 2		
Max. radial displacement with $n=1500$ rpm ΔK_r [mm]	± 1.1	± 1	± 0.5	± 1.6	± 1.5	± 0.7	± 1.8	± 1.7	± 0.8	± 2.2	± 2	± 1	± 2.5	± 2.3	± 1.1
Max. radial displacement with $n=3000$ rpm ΔK_r [mm]	± 0.55	± 0.5	± 0.25	± 0.8	± 0.75	± 0.35	± 0.9	± 0.85	± 0.5	± 1.1	± 1	± 0.5	± 1.25	± 1.15	± 0.55
Max. angular displacement with $n=1500$ rpm ΔK_w [degree]	± 1	± 0.75	± 0.5	± 1	± 0.75	± 0.5	± 1	± 0.75	± 0.4	± 1	± 0.75	± 0.5	± 1	± 0.75	± 0.5
Max. angular displacement with $n=3000$ rpm ΔK_w [degree]	± 0.5	± 0.4	± 0.25	± 0.5	± 0.4	± 0.25	± 0.5	± 0.4	± 0.5	± 0.5	± 0.25	± 0.25	± 0.5	± 0.4	± 0.25

EVOLASTIC®

Highly flexible shaft couplings

BoWex-ELASTIC® HEW Compact